

ITEM 13. MOBILE CRANES – TEMPORARY ROAD CLOSURES – GROSE STREET GLEBE

TRIM RECORD NO: 2016/302886

RECOMMENDATION

It is recommended that the Committee endorse the temporary road closure of Grose Street, between Bay and Francis Streets, Glebe, from 9pm on Tuesday 2 August to 5am on Wednesday 3 August 2016, subject to the following conditions:

- (A) The Applicant must comply with the temporary road closure conditions as mentioned in Schedule C of this Agenda.
- (B) The Applicant must comply with any other conditions imposed by City's Construction Regulation Unit.
- (C) The Applicant has indicated 9pm on Wednesday 3 August to 5am on Thursday 4 August 2016 as an alternative date for the above work as a contingency for inclement weather.
- (D) The Applicant must contact Leichhardt Police to obtain a separate police permit and to discuss deployment of user pay police for the road closure.
- (E) The Applicant is to obtain a Road Occupancy Licence from the Transport Management Centre prior to commencement of works.
- (F) The Applicant must provide a telephone number of the supervisor responsible for the proposed closure and include contact details in the notification letters to be distributed to affected stakeholders.

VOTING MEMBERS FOR THIS ITEM

<i>Voting Members</i>	<i>Support</i>	<i>Object</i>
City of Sydney		
Roads and Maritime Services		
NSW Police – Leichhardt LAC		
Representative for the Member for Balmain		

DECISION

BACKGROUND

Construction Solutions has applied for the temporary road closure of Grose Street, between Bay and Francis Streets, Glebe, from 9pm on Tuesday 2 August to 5am on Wednesday 3 August 2016.

COMMENTS

The proposed temporary road closure is required to allow a mobile crane to replace the air-conditioning unit on the rooftop of Broadway Shopping Centre.

The Applicant has provided a site-specific Traffic Control Plan that includes details of barricades, signs, flagmen and other traffic devices to implement the proposed road closure.

There are currently no other approved temporary road closures proposed to take place on the same day in close proximity of this closure.

The temporary road closure will not affect any other properties, as local access will be provided at all times and alternative access routes are available nearby.

A Traffic Management Plan (TMP) for the temporary road closure was approved by Roads and Maritime Services (RMS).

CONSULTATION

The Applicant will be required to notify affected stakeholders as stipulated in Schedule C.

FINANCIAL

All costs associated with the proposed closures will be borne by the Applicant.

ATTACHMENTS

Mobile Cranes – Temporary Road Closures – Grose Street Glebe

Ajay Nayyar, Traffic Works Coordinator

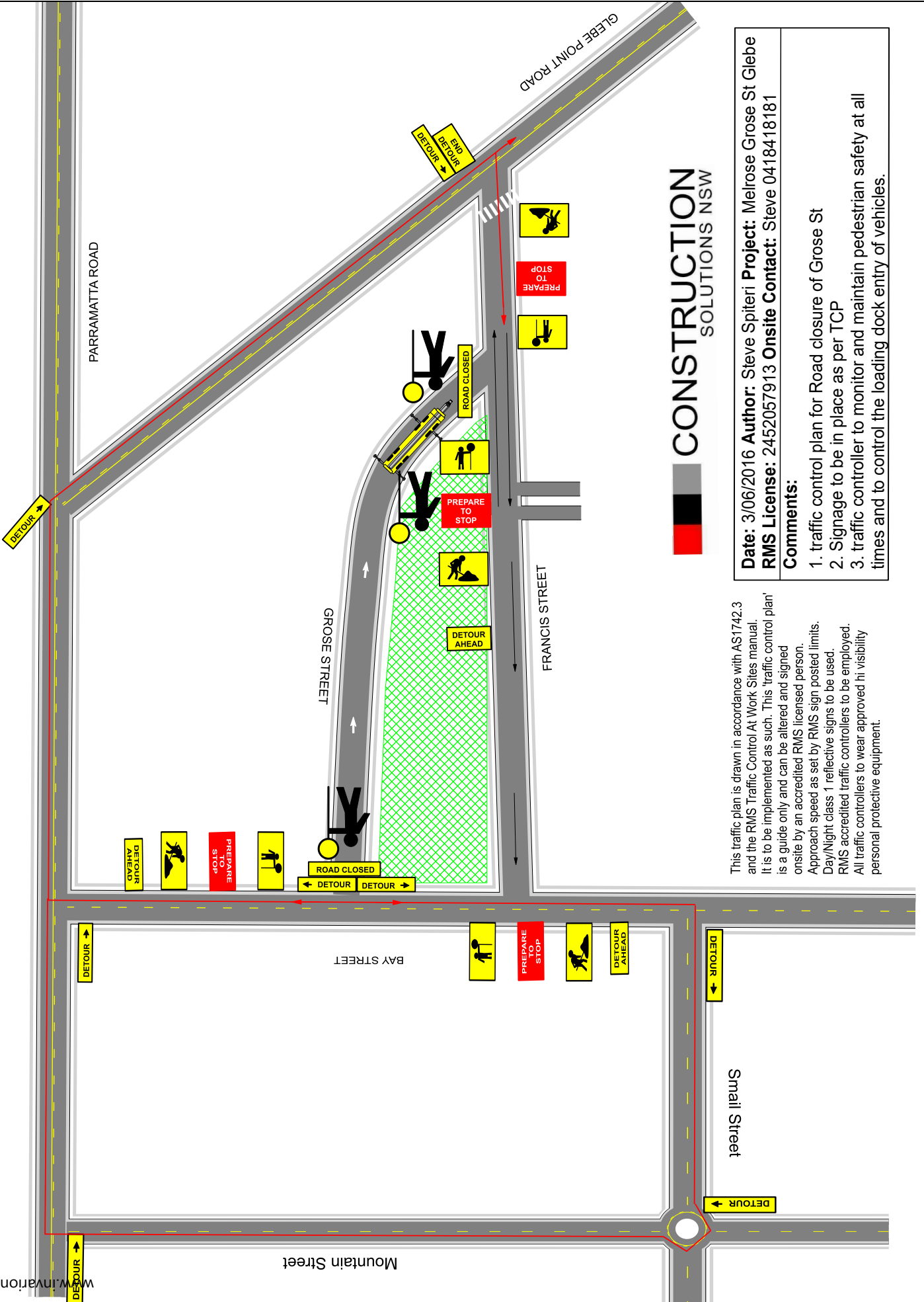

This traffic plan is drawn in accordance with AS1742.3 and the RMS Traffic Control At Work Sites manual. It is to be implemented as such. This 'traffic control plan' is a guide only and can be altered and signed onsite by an accredited RMS licensed person. Approach speed as set by RMS sign posted limits. Day/Night class 1 reflective signs to be used. RMS accredited traffic controllers to be employed. All traffic controllers to wear approved hi visibility personal protective equipment.

Date: 3/06/2016 **Author:** Steve Spiteri **Project:** Melrose Grose St Glebe
RMS License: 2452057913 **Onsite Contact:** Steve 0418418181

Comments:

1. traffic control plan for Road closure of Grose St
2. Signage to be in place as per TCP
3. traffic controller to monitor and maintain pedestrian safety at all times and to control the loading dock entry of vehicles.

